



## **Tender for Renovation of Gymnasium at NBSC & BIRD Campus – Civil and Electrical Works**

**Location – NABARD Campus , Aashiyana Chauraha, Sector – H, LDA colony**

**For empanelled contractors only**



**Department of Premises, Security and Procurement, NBSC  
Lucknow , NABARD**

**E-mail - [dpsp.nbsc@nabard.org](mailto:dpsp.nbsc@nabard.org)**

**Last date for submission of Tender: 14 February 2025 @ 1530 Hrs.**

Name of the Empanelled Contractor	
Address of the Empanelled Contractor	
Contact Person & Mobile/ Telephone No.	



REF. NO. NB. NBSC.DPSP/GYM/ 131195 /2024-25

Date: 23 January 2025

**The Empanelled Contractors**  
**(as per list attached as Annexure - I)**  
**Dear Sir,**

I. निविदा आमंत्रण सूचना  
**I.NOTICE INVITING TENDER**

**Notice Inviting Tender for Renovation of Gymnasium at NBSC & BIRD Campus  
– Civil and Electrical Works**

1. NABARD intends to undertake the work of “Renovation of Gymnasium at NBSC & BIRD Campus- Civil and Electrical Works” at NABARD Campus located at Aashiyana Chauraha, , Sector-H LDA Colony ” and therefore, invite offer from the empanelled contractors of category III.
2. Applicants are requested to submit their offer in sealed envelope (in Tender Box at NBSC) for the aforesaid work as per terms and conditions and other requirements as mentioned more specifically elsewhere in this quotation document. Last date for submission of Tender is **14.02.2025 @ 1530 Hrs.**
3. **Time of Completion: The time of completion for the total work shall be 01 month from the date of issue of work order.**
4. NABARD reserves the right to accept or reject any /all quotation/s in part or whole of any firm / firms without assigning any reasons for doing so.
5. **The bidders are advised to conduct a site survey and satisfy themselves about the overall feasibility of work.**
6. The Tender shall be accepted only in respect of those bidders whose quotations are in line with the requirements as per the quotation document, and if the same is acceptable to NABARD. The decision of NABARD in this regard shall be binding on the bidders and not open to questions or appeals.
7. Quotations received later than the time and date prescribed, on account of any reason whatsoever as also telegraphic and faxed quotations shall not be considered.

Sd/-

(Jayant Vishnu)  
Deputy General Manager



## II. FORM OF Tender

The Principal,  
National Bank Staff College,  
Lucknow – 226012

Date:-

Dear Sir,

### **Notice Inviting Tender for Renovation of Gymnasium at NBSC & BIRD Campus – Civil and Electrical Works**

1. Having examined the quotation document relating to the works specified in the Memorandum hereinafter set out, having visited and examined the site of the works specified in the said Memorandum and having acquired the requisite information relating thereto as affecting the quotation, I/We hereby offer to execute the works specified in the said Memorandum within the time specified, at the rates mentioned in the Price Bid; in all respects of the quotation and with such materials as are provided for, in accordance with such conditions in so far as they may be applicable.

#### **2. MEMORANDUM**

<b>S. No.</b>	<b>Subject</b>	<b>Specification</b>
I	Description of work	<b>Notice Inviting Tender for Renovation of Gymnasium at NBSC &amp; BIRD Campus – Civil and Electrical Works</b>
II	Estimated Cost	Rs. 7,84,706/- (Excluding GST)
III	Time allowed for completion of the work	The time allowed for completion of total project is 1 month. reckoned from the date of issue of work order.
IV	Retention Money Deposit (RMD)/ Security Deposit (SD)	Security Deposit (SD) / Retention money deposit (RMD) shall be deducted @ 5% of the value of work done from bill (subject to maximum of 5% of actual values of Works carried out) and it shall be refunded after expiry of defect liability period of one year after the date of virtual completion of the work, provided the Contractor has satisfactorily carried out all the rectification works and attended to all defects to the satisfaction of NABARD. No interest will be paid on Security



		Deposit/Retention Money. No mobilisation advance will be given to contractor.
--	--	---

3. Should this quotation be accepted, I/We hereby agree to abide by and fulfil the terms and provisions or the said conditions of the quotation annexed hereto as far as they may be applicable or in default thereof, to pay to the National Bank for Agriculture and Rural Development, the amount mentioned in the said quotation conditions.

4. I/We agree to pay Government all applicable taxes prevailing from time to time.

Our Bankers are:

- i) ..... Bank, ..... Branch,..... , Lucknow
- ii) ..... Bank, ..... Branch,..... , Lucknow
- iii) Type of account : Savings / Current account
- iv) Bank Account No.:
- v) IFS code of Bank and branch:

The names of partners of our firm are:

- i)
- ii)
- iii)

Name of the partner of the firm

Authorized to sign:

OR

Name or person having Power of

Attorney / Authorisation letter to sign the contract

Yours faithfully,

Signature of Tenderer with stamp



### **III. GENERAL CONDITIONS**

- a. Vendors are advised to visit the site and thoroughly understand the nature and scope of the works and be familiar with the site conditions before quoting the rates.
- b. Quoted rates should be workable and reasonable and should include incidental and all overheads and profits. The vendor should furnish Rate Analysis for scrutiny of the rates by NABARD, if required.
- c. Rates should include all Taxes, Duties, Octroi, Levies, Wages as per Act, etc. and should be firm for the entire Work period. No escalation in rates will be allowed for the entire work period on any account.
- d. Retention Money Deposit (RMD)/ Security Deposit (SD): Security Deposit (SD) / Retention money deposit (RMD) shall be deducted @ 5% of the value of work done from bill (subject to maximum of 5% of actual values of Works carried out) and it shall be refunded after expiry of defect liability period of one year after the date of virtual completion of the work, provided the Vendor has satisfactorily carried out all the rectification works and attended to all defects to the satisfaction of NABARD. No interest will be paid on Security Deposit/Retention Money.
- e. Materials used should conform to relevant BIS/IS Codes.
- f. The items not covered in the Schedule of Quantities of the Quotation shall be paid at CPWD rates/ the rates as per Rate Analysis based on the market prices supported by documentary proof with 15% towards Vendor's Overheads and profit plus GST, as applicable. The Rate Analysis shall be submitted by the Vendor for scrutiny and approval of NABARD.
- g. Income Tax, Goods and Service Tax, Works Work Tax and other taxes etc. as applicable will be deducted from total payment due to the Vendor, in the form of TDS.
- h. The entire work is required to be completed as specified in the quotation.
- i. The Vendor shall be fully responsible and shall compensate NABARD in the event of any damage to men or material, injury / damage or death as the case may be, caused directly or indirectly due to the negligence of the Vendor or his agents and / or his employees, or workmen. The decision of NABARD in this regard shall be final and binding.
- j. In case of any default or failure on Vendor's part to comply with all / any one of the Terms / Conditions, NABARD reserves to itself the right to take necessary steps to remedy the situation including, inter-alia, the deduction of appropriate amount/s from dues otherwise payable to Vendor and / or by taking recourse to appropriate recovery proceedings.
- k. The work should be carried out with least inconvenience to the occupants. The workmen employed by the Vendor should abide by the Rules and Regulations maintained by NABARD in the premises, especially in respect of working hours, entry of the workers to the premises, interpersonal relation with the occupants etc.
- l. The Vendor should obtain approvals, if any, necessary for the work from the statutory bodies on behalf of NABARD. However, NABARD may assist the Vendor in respect of any liaison with the Municipal or any other authority for necessary approval / permission with regard to the construction/maintenance works. The fees and other statutory charges, if any, will be reimbursed to the Vendor based on the original receipts produced to NABARD.
- m. The Work can be terminated by NABARD on 15 days' notice if services are found to be unsatisfactory and if there is no improvement even after issue of three notices to the vendor.
- n. On-site storage space will be provided to the Vendor subject to availability.
- o. The Vendor shall provide all necessary items/equipment etc. for the proper execution of the works.
- p. The Vendor shall not directly or indirectly transfer, assign or sublet the Work or any part of it, without written permission of NABARD.



- q. Any defect which may appear within the Defect Liability Period (one year after the Virtual Completion of work) should be rectified by the vendor at his cost.
- r. Vendor shall work as per the design attached herewith.
- s. Payment shall be made based on final measurement and issuance of completion certificate by M/s Mohit & Associates, the architectural design cum project management consultant hired for this project.
- t. **Defects Liability Period:** One year from the date of issuing Virtual Completion Certificate (Annexure-II) of works certified by NABARD.
- u. **Warranty:** 3-year warranty for all electrical or electronic items installed.
- v. **Payment Terms:**
  - 1. No Mobilisation advance shall be paid.
  - 2. 95% against completion of work.
  - 3. Remaining 5% after Defect Liability Period of one year
  - 4. The value of the bill is to be more than Rs. 5.00 lakhs
- w. The quotations shall be signed by the person/ persons on behalf of the organization having necessary Authorization/ Power of Attorney to do so. Each page of the application shall be signed and sealed.
- x. Quotations containing false and/ or incomplete information are liable for rejection.
- y. The applicant shall quote the rates for each item in the Price bid as per scope of work.
- z. Quotations with specific conditions/Conditional quotations shall be rejected.

**We accept all the above Terms and Conditions in all respects without any reservation.**

Place :

DATE :

**Seal and Sign of the Vendor**



#### **IV. SPECIAL CONDITIONS OF CONTRACT**

1. The Quotation is strictly on Item Rate basis.
2. The Vendor may sign all the pages of the Quotation Document.
3. NABARD takes no responsibility for delay/loss in post or non-receipt of Quotation Documents.
4. **Bids submitted by un-authorized agents and FAX / Telex / Telegraphic bids/E-Mail shall not be entertained/considered.**
5. Vendors are advised to visit the site at their cost, conduct survey of existing conditions so as to familiarize themselves with the site conditions, nature of works etc. and get all clarifications as necessary from NABARD before quoting the rates.
6. Rates should include for removal of debris out of premises to the safe limit, removing stains, cleaning the site thoroughly and unless the same is done to the satisfaction of the NABARD's officials, the Bill will not be accepted.
7. The vendors shall make necessary arrangement for watch and ward of his materials, tools, machines etc. stored for the execution of the work at his own risk and cost and NABARD will not be responsible on any account.
8. If the last date of receipt of Quotation is a holiday, then submission of Quotations shall be shifted to next working day without change of time and venue.
9. The Vendors should quote their rates strictly adhering to Terms and Conditions stipulated in the Quotation Document. Unsolicited correspondence after opening of the Quotation shall not be entertained. Conditional / deviational quotations may be rejected without making any reference to the Vendors.
10. No Vendor will be allowed to withdraw his Quotation during the validity period. Subletting of the Work is not permitted.
11. Rates should be filled in the Quotation neatly and as far as possible, no correction shall be made. The rates quoted should be written legibly in words and figures. If on check, differences are observed between the rates given by the Vendor in words and figures or in the amount worked out by him, the following procedure shall be followed.
  - a. When there is a difference between the rates in figures and in words the rates which corresponds to the amounts worked out by the Vendor shall be taken as correct.
  - b. When the amount of an item is not worked out by the Vendor or it does not correspond with the rate written either in figures or in words, then the rate quoted by the Vendor in words shall be taken as correct.
  - c. When the rates quoted by the Vendor in figures and in words tallies, but the amount is not worked out correctly, the rate quoted by the Vendor shall be taken as correct and not the amount.
12. No advance shall be paid towards mobilization and cost of materials.
13. The Vendor shall use necessary safety equipment and maintain all safety measures during the execution of works and ensure compliance of Safety Code as per Rules and Regulations in force.
14. The Vendor should have necessary Work License and comply with the Labour Laws as applicable.
15. Notwithstanding anything stated above, NABARD reserves the right to assess the Vendor's capability and capacity to perform the contract, should the circumstances warrant such assessment in the overall interest of NABARD.
16. The decision of NABARD in awarding the work shall be final and cannot be subjected to arbitration.



17. NABARD reserves the right to accept/ negotiate / reject any Quotation either in whole or in part without assigning any reasons therefore whatsoever and without entering into any further correspondence and hence, NABARD shall be under no obligation to accept the lowest or any other Quotations received in response to this Quotation. The decision of NABARD in this regard shall be final and undisputable.
18. NABARD also reserves the right of super session of any of the conditions, stipulated in the Quotation Document.
19. Validity of Rates quoted by the vendor may be extended further with mutual consent of NABARD and the vendor.

#### **DECLARATION BY THE VENDOR**

**We / I have read and understood all the instructions / conditions made above and we / I have taken into account the above Instructions / Terms and Conditions while quoting the rates. We / I accept all the above Terms and Conditions without any reservation, in all respects.**

Place:

DATE:

(SIGNATURE OF THE VENDOR)

NAME and SEAL

ADDRESS:





<b>SUMMARY FOR INTERIOR FURNISHING WORK FOR NBSC-GYNESIUM</b>		
<b>S.NO</b>	<b>DESCRIPTION</b>	<b>AMOUNT (Rs.)</b>
A	<b>SCHEDULE - 'A' (FURNISHING WORK)</b>	
	<b>TOTAL SCHEDULE " A "</b>	
B	<b>SCHEDULE - 'B' ( ELECTRICAL WORK )</b>	
	<b>TOTAL SCHEDULE "B "</b>	
<b>TOTAL ( SCHEDULE - A+B)</b>		
	<b>IF ANY DISCOUNT</b>	
	<b>DISCOUNT AMOUNT</b>	
	<b>GRAND TOTAL</b>	
	<b>NOTE :- GST (WCT) TAX WILL BE EXTRA.</b>	
	<b>Contractor Signature &amp; Seal</b>	
<b>GST No:-</b>		



**VI. SCHEDULE OF QUANTITIES/ PRICE BID**

<b>A) SCHEDULE - 'A' (CIVIL WORK)</b>					
<b>Sl.No.</b>	<b>Item Description</b>	<b>Unit</b>	<b>Quantity</b>		
				<b>Rate(Rs)</b>	<b>Amount (Rs)</b>
	<b>DISMANTLING AND DEMOLITION</b>				
1	Dismantling of the existing old flooring tiles of any description along with the bedding layer and carting away the debris outside the premises to place not objected by the local civic authorities including all lead, lift, tolls, labour etc complete all as specified and directed by Officer in charge.	Sqft	50.00		
2	Dismantling of the existing old wall tiles of any description along with the backing coat and carting away the debris outside the premises to place not objected by the local civic authorities including all lead, lift, tolls, labour etc complete all as specified and directed by Officer in charge.	Sqft	180.00		
3	Dismantling of the existing PCC of any description and carting away the debris outside the premises to place not objected by the local civic authorities including all lead, lift, tolls, labour etc complete all as specified and directed by Officer in charge.	Cuft	36.00		
4	Dismantling of the existing filled material (brickbat coba/Surkhi) of any description from sunken slab of washrooms and carting away the debris outside the premises to place not objected by the local civic authorities including all lead, lift, tolls, labour etc complete all as specified and directed by Officer in charge.	Cuft	36.00		
5	Dismantling and removing the Concealed water lines/sewage lines pipelines of any description, Water closet, washbasins, plumbing fittings etc from from the washrooms of following area and carting away the debris outside the premises to place not objected by the local civic authorities including all lead, lift, tolls, labour etc complete all as specified and directed by Officer in charge.				
a)	Washroom of Size (6 feet X 6 feet) - approx.	Per job	1.00		

6	Dismantling and removing doors and windows wherever required in a manner which facilitates easy fixing of new doors and windows without undue expense. the rate shall include removal of debris from site.	Nos	8.00		
	<b>BRICK WORK, PLASTERING AND CONCRETE WORKS</b>				
7	Constructing 6" thk. Brick wall in 1:6 cement mortar. Brick used shall be of best quality kiln burnt, having sharp edges & giving clear ringing sound when struck against each other. The rate shall be inclusive of plastering the walls with 3/4" thk. 1:4 cement plaster on both sides. A 4 1/2" R.C.C. Patti Beam shall run horizontally @ 3'-0" c/c. The rate shall be inclusive of any scaffolding required, curing etc, complete.	Sqft	45.00		
8	Rendering in cement mortar 1:4, 20mm thick avg thickness <b>in patches</b> as per site condition over brick/concrete surfaces and finishing the surfaces even and smooth using extra cement including necessary curing, etc., complete all as specified and directed by the Officer-in-charge. <b>Note:</b> The rate quoted for the item deemed to include for providing and removal of scaffolding wherever necessary .	Sqft	50.00		
9	Providing & laying water proofing treatment in washrooms, by applying cement slurry mixed with water proofing cement compound consisting of applying (a) first layer of slurry of cement @ 0.488 kg/ sq.m mixed with water proofing cement compound @ 0.253 kg/ Sq.m. This layer will be allowed to air cure for 4 hours. (b) Second layer of slurry of cement @0.242 kg/ Sq.m mixed with water proofing cement compound @ 0.126 kg/ Sq.m. This layer will be allowed to air cure for 4 hours followed with water curing for 48 hours. The rate include, preparation of surface, treatment and sealing of all joints, corners, junctions of pipes and masonry with polymer mixed slurry etc. complete all as specified and directed by Officer in charge.	Sqft	60.00		
<b>10</b>	<b>Additional PCC in Flooring 1:2:4 for laying of tiles</b>				

	While arriving at the rate for Flooring of Tiles, we have envisaged a PCC back filling of 3". If at any site, the thickness of PCC to be laid is coming more than 3", Bank / Architect should be informed before carrying out the work. The additional thickness will be paid in area measurement with a rate of Rs.12.50/Sft for every additional thickness of 1". The payment for the same will be considered only if the contractor informs the Bank before carrying out the works.	Sqft	50.00		
	<b>FLOOR/WALL TILES</b>				
11	Providing and fixing <b>Vinyl flooring</b> of 2mm thick PVC flexible, homogeneous antistatic calendared compacted floor covering, minimum weight 3120 g/m <sup>2</sup> in minimum sheet of size 2mtrs. x 20 mtrs. approved pattern & colour combination with PUR Protect or equivalent surface treatment having wear minimum resistance of $\leq 4.0\text{mm}^3$ as per EN 660.2 and wear group P as per EN649 and should have a minimum residual indentation of $<0.03\text{mm}$ confirming to EN-433. The laid flooring should have non- directional design, colour dyed as a raw mixture to ensure even colour throughout the thickness and its surface should be densely compacted for improving wear and ease of maintenance with Anti-bacterial and Fungicidal properties. The laid flooring shall confirm the fire rating B1 class as per EN 13501-1. The floor finish should terminate at the room perimeter passing over a concealed cove former and continuing up the wall for 100mm. The joints in the flooring should be sealed by using a PVC welding bar of matching colour to be supplied by the manufacturer, using a hot air gun for fusion of welding bar with flooring and self levelling required underneath with all accessories cove etc.. complete all as specified & directed by Engineer-in-charge	Sqft	750.00		

12	Supplying and laying antiskid ceramic tiles of size 300mm X 300mmx8mm or bigger size of first quality, approved brand and shade/design and colour, conforming to relevant IS, Manufactured by M/s.Johnson/Kajaria/Nitco and laid in cement slurry over bedding layer of cement mortar 1:4, 20mm thick and curing. The joints should be neatly finished with white/coloured cement using matching pigment etc., complete all as specified and directed by Officer-in-charge. Note: The rate quoted for the item deemed to include for call wastages				
a)	Basic cost of tiles not less than Rs _80 Sft	Sqft	40.00		
13	Supplying and fixing glazed ceramic tiles dadoo tiles of size 450mmX600mm or bigger size of first quality, conforming to relevant IS, approved shade/design and colour, Manufactured by M/s.Johnson / Kajaria/Nitco fixed in cement slurry, over a backing coat of Cement mortar 1:4, 15 mm thick and curing. The joints shall be neatly finished with white/coloured cement using matching pigment and shall be neatly maintained etc., complete all as specified and directed by Officer-in-Charge. Note: The rate quoted for the item deemed to include wastages				
a)	Basic cost of tiles not less than Rs 90 Sft	Sqft	240.00		
14	Supplying and fixing new 30 mm thick, polished Granite slab of approved shade/colour with bullnosed edges for Cooking platform/washbasin counter including cutting for provisions for fixing washbasin/ss sink etc., complete all as specified & directed by Officer in charge . <b>Note:</b> The rate quoted for the item deemed to include wastages	Sqft	10.00		
15	Providing & fixing 3/4" thk Granite for door frames in vertical jambs & soffit, with outer part of 4" width and inner part of 2" width fixed on walls with a difference of 1/2" for door shutter, including machine polish on exposed edges and rounding of corners, necessary backing material, and joint filling compound of same shade of Granite. <b>Note:</b> The rate quoted for the item deemed to include wastages	Rft	150.00		
	<b>PLUMBING FITTINGS</b>				

16	Supplying and fixing following diameter CPVC pipeline 1st quality approved brand such as M/s.Supreme/ Astral/Ashirvad make conforming to relevant IS including concealing the pipes by cutting chases/grooves in the walls and making good the wall surfaces.The quoted rate shall be deemed to be inclusive of all fittings / fixtures, such as bends, elbows, tees, connectors, caps, plugs, sockets, brass MTA/FTA, adaptar,unions, teflon tape, paste, all lead, lift, tools, labour etc., complete all as specified and directed by the Officer-in-charge.				
a)	15mm diameter	Rft	20.00		
b)	20 mm diameter	Rft	10.00		
c)	25mm diameter	Rft	5.00		
17	Providing and fixing 20mm diameter CPVC gate valve of approved brand etc., complete all as specified and directed by Officer-in-charge.	Nos	1.00		
18	Supply and fixing following Dia lever operated Gun Metal ball valve of first quality, approved brand & Make, conforming to relevant IS, Manufactured by M/s Zoloto/Tyco/Audco including suitable CP brass ball & spindle, glass filled teflon seating, gland packing, union, nipple other necessary fittings/fixtures etc., complete all as specified and directed by Officer-in-charge Note : Rate quoted for the item deemed to include for providing and removal of scaffolding/staging wherever necessary				
a)	20mm diameter	Nos	1.00		
b)	25 mm diameter	Nos	1.00		
c)	32mm diameter	Nos	1.00		
19	Supply and fixing following dia,6kg/cm <sup>2</sup> SWR PVC pipes of first quality, approved brand, conforming to relevant IS, Manufactured by M/s Supreme/Finolex/Prince jointed with rubber ring with good quality of lubricant in shafts/sunken slab/under slab with solvent cement including all necessary fittings such as bends, tees, offsets, junctions, pan connector, cowls etc., laid under floor/ under ceiling/ on walls with suitable clamps and curing etc., complete				



	all as specified and directed by Officer-in-charge.				
a)	75mm dia	Rft	20.00		
b)	110mm dia	Rft	10.00		
20	Providing and fixing Nahani trap of first quality approved brand, etc., complete all as specified & directed by Officer-in-charge.	Nos .	2.00		
21	Providing and fixing Gully trap of first quality approved brand, for bathroom outlet etc., complete all as specified & directed by Officer-in-charge.	Nos .	2.00		
22	Supplying and fixing 100mm diameter brass chromium plated grating of first quality approved brand etc. complete all as specified & directed by Officer-in-charge	Nos .	2.00		
	<b>SANITRAY FITTINGS FOR WASHROOMS</b>				
23	Supplying and fixing vitreous chinaware wall mounted European type water closet of first quality, conforming to relevant IS, approved size/shape/brand and colour, Manufactured by M/s Jaquar or equivalent including seat cover, Metropole Flaushvalves Dual, inlet valve, valve holder, discharge valve, flushing bend pipe, flushing straight pipe, toilet rubber and chrome plated flush plate, drain outlet fittings and necessary all fitting and fixtures etc., complete all as specified and directed by the Officer- in-charge (Basic cost of water closet shall not be less than Rs 15,000/-).	Nos .	1.00		
24	Supplying and fixing new over counter hand wash basin of required size of first quality, approved size/shape/colour and brand, conforming to relevant IS, Manufactured by M/s. Jaquar or equivalent including 450 mm long PVC connection pipe, brass chromium plated angle cock, 32 mm diameter brass Chromium plated waste coupling etc., complete all as specified and directed by	Nos .	1.00		

	Officer-in-Charge.(Basic cost of washbasin shall not be less than Rs 5000/-).				
25	Supplying and fixing Brass chromium plated Bottle Trap with connection pipe and wall flange of first quality, approved brand , Manufactured by M/s Jaquar or equivalent, conforming to relevant IS,etc., complete all as specified and directed by Officer-in-Charge	Nos .	1.00		
26	Supplying and fixing new Health faucet with 8mm dia, 1m long Flexible tube with wall Hook of first quality, approved brand, conforming to relevant IS, Manufactured by M/s Jaquar (Allied series) equivalent etc., complete all as specified and directed by Officer-in-charge	Nos .	1.00		
27	Supplying and fixing Brass Chromium plated Toilet paper holder of first quality, approved brand, conforming to relevant IS, Manufactured by M/s Jaquar (Queen's series) or equivalent etc., complete all as specified and directed by Officer-in-charge.	Nos .	1.00		
28	Supplying and fixing brass chromium plated double coat hook of first quality, approved brand, conforming to relevant IS, Manufactured by M/s Jaquar (Queen's series) or equivalent etc., complete all as specified and directed by Officer-in-charge.	Nos .	1.00		
29	Supplying and fixing brass chromium plated Robe hook of first quality, approved brand, conforming to relevant IS, Manufactured by M/s Jaquar (Queen's series) or equivalent etc., complete all as specified and directed by Officer-in-charge.	Nos .	1.00		
30	Supplying and fixing brass chromium plated Pillar cock of first quality, approved brand, conforming to relevant IS, Manufactured by M/s Jaquar (Florentine series) or equivalent etc., complete all as specified and directed by Officer-in-charge.	Nos .	1.00		



31	Supplying and fixing corner Glass shelf with bracket of first quality, approved brand, conforming to relevant IS, Manufactured by M/s Jaquar (Continental series) or equivalent etc., complete all as specified and directed by Officer-in-charge.	Nos .	1.00		
32	Supplying and fixing brass chromium plated 2 way Bibcock of first quality, approved brand, conforming to relevant IS, Manufactured by M/s Jaquar (Florentine series) or equivalent etc., complete all as specified and directed by Officer-in-charge.	Nos .	1.00		
33	Supplying and fixing brass chromium plated Tumbler Holder of first quality, approved brand, conforming to relevant IS, Manufactured by M/s Jaquar (Queen's series) or equivalent etc., complete all as specified and directed by Officer-in-charge.	Nos .	1.00		
34	Supplying and fixing brass chromium plated Soap dish of first quality, approved brand, conforming to relevant IS, Manufactured by M/s Jaquar (Queen's series) or equivalent etc., complete all as specified and directed by Officer-in-charge.	Nos .	1.00		
35	Supplying and fixing brass chromium plated towel rack with lower hanger of first quality, approved brand, conforming to relevant IS, Manufactured by M/s Jaquar (Hotelier series) or equivalent etc., complete all as specified and directed by Officer-in-charge.	Nos .	1.00		
36	Supplying and fixing brass chromium plated towel ring of first quality, approved brand, conforming to relevant IS, Manufactured by M/s Jaquar (Queen's series) or equivalent etc., complete all as specified and directed by Officer-in-charge.	Nos .	1.00		
37	Supplying and fixing brass chromium plated Concealed Stop cock of first quality, approved brand, conforming to relevant IS, Manufactured by M/s Jaquar or equivalent etc., complete all as specified and directed by Officer-in-charge.	Nos .	2.00		

38	Supplying and fixing brass chromium plated Angle cock of first quality, approved brand, conforming to relevant IS, Manufactured by M/s Jaquar or equivalent etc., complete all as specified and directed by Officer-in-charge.	Nos .	2.00		
39	Supplying and fixing brass chromium plated liquid soap dispenser of first quality, approved brand, conforming to relevant IS, Manufactured by M/s Jaquar or equivalent etc., complete all as specified and directed by Officer-In-Charge.	Nos .	1.00		
40	Supplying and fixing Hand dryer of first quality, approved brand, Manufactured by M/s Euronics (Model No :EHO2 ABS ) or Equivalent from M/s Kholer etc complete all as specified and directed by Officer in charge.	Nos .	1.00		
	<b>WOODEN WORKS</b>				
41	Providing and fixing modular type storage units (As per the drawing) made out of 19mm thick BWP plywood. The exposed surfaces of cabinets shall be finished with 1 mm thick laminate of approved shade and colour with two coats of Melamine polish and inside surfaces shall be finished with 0.80mm thick white laminate with wooden lipping allround.The interior of the unit shall have drawers and locker arrangement including all brass hardware such as hinges, sliding channel, door handle, drawer pull, drawer channels of M/s Hettich or equivalent and locks of Godrej/Europa make etc., complete all as shown in drawing and specified and directed by the Officer- in - charge. <b>Note :</b> <b>a)</b> Make of Plywood, Venner and laminate shall be of M/s Archidply/Kitply/Green ply/Century. <b>b)</b> Glass shall be measured under relevant item and paid seperatley <b>c)</b> Rate quoted for the item deemed to include all wastages	Sqft	45.00		
42	<b>Full height Mirror :</b> Providing & Fixing mirror which shall be of 8mm thick mirror with bevelled edges of first quality, approved brand, Manufactured by M/s Saintgobain/Modiguard with plywood backing and designer beading.	Sqft	715.00		

43	Supplying and fixing Interlocking Tiles Floor Mats for Gym Equipment/Yoga 25 MM Thickness Exercise & Gym Mat all as specified and directed by Officer in charge: <b>Note : a)</b> Make M/s Supreme /singatron / mundet	Sqft	210.00		
44	Providing and fixing relamination work on on existing door with paint complete all as specified and directed by Officer in charge: <b>Note : a)</b> Make shall be of M/s Archidply/Kitply/Greenply/Century	Sqft	42.00		
<b>GLAZING WORKS</b>					
45	<b>Main entrance Glass Door :</b> Providing and fixing aluminium entrance doors with 8 mm floatglass as/design with top & bottom section of 45 by 90mm , 2mm thick section of hindalco/indal anodized in approved colour with 25 micron anodizing along with SS C shaped handles of kitch or equivalent make along with floor spring of hemco/everite make. The item also includes door lock completed to the satisfaction of the architect. etc complete all as specified and directed by Officer in charge. Note : Rate quoted for the item deemed to include all wastages.	Sqft	45.00		
<b>UPVC WINDOWS</b>					
46	Providing and fixing uPVC Single glazed windows (Openable/fixed) of M/s Fenesta or equivalent make, approved shade and colour of frames, with profile made out UPVC sections of 3000 series with shutters fitted with 5.50mm thick clear glass of approved quality like weather sealed beading, gaskets etc to make them weather protector and free from rattling and all standard hardware like screws, nails protected section etc complete to suit the overall size of openings as specified and directed by manufacturers instruction.	Sqft	65.00		
<b>FALSE CEILING</b>					

47	<p>Supplying and fixing gypsum board designer false ceiling (at different levels) in G.I. frame in 24 to 26 guage main frame bottom to bottom distance at 600mm, with cross patties at 450mm centre to centre with 24 to 26 guage angle cleats size 25mm X 25mm supported at 750 mm centre to center with 12 mm gypsum ceiling board of first quality, approved brand, conforming relevant IS, Manufactured by M/s Saintgobain/India Gypsum/Armstrong with sheet metal screws etc complete including provision for diffused cove lighting including applying of two coats of plastic emulsion paint over two coats of putty and two coats of primer of first quality, approved brand, confriming to relavent IS, manufactured by M/s Asian paints/Berger paints and to achive perfect level.The rate shall be inclusive of cutouts for lights. The ceiling shall be in perfect level and smooth in finish etc. all complete and as specified and directed by Officer in charge. <b>Note :</b> Rate quoted for the item deemed to include all wastages</p>	Sqft	350.00		
48	<p>Supplying and fixing Grid false ceiling with 600mmX600mm size design calcium silicate tiles of first quality, approved brand and design, manufactured by M/s Armstrong/Aerolite and suspension concealed systems made out of galvanised steel of 600mmX600mm module suspended to the soffit by a propritery 4mm dia adjustable quick fit hanger system comprise main runners spaced at 1200mm centres securely fixed to the structral soffit by approved hangers at 1200mm maximum centres and not more than 150mm from spliced joints. The last hanger at the end of each runner should not be greater than 600 mm from the adjacent wall complete all manufacturers instructions. <b>Note :</b> Rate quoted for the item deemed to include all wastages</p>	Sqft	600.00		
	<b>BLINDS</b>				

49	Supplying and fixing Roller blinds with fabric of first quality, approved shade and colour, manufactured by M/s Marc/Vista etc complete all as specified and directed by Officer in charge. <b>Note: a)</b> Rate quoted for the item deemed to include for wastages. <b>b)</b> Window area shall be considered for payment. <b>c)</b> Basic cost of fabric shall not be less than Rs ___120___ Sft	Sqft	60.00		
	<b>PAINTING</b>				
50	<b>Wall Putty :</b> Providing and applying white cement based putty of average thickness 1.0mm of first quality, approval brand, manufactured by M/s Birla for wall surface to prepare the surface even and smooth including necessary repairs to cracks/scratches etc., complete all as specified and directed by Officer in charge. <b>Note:</b> Rate quoted is deemed to include for <b>a)</b> Providing and removal of scaffolding wherever necessary <b>b)</b> Covering doors, windows, floors, fittings etc to protect from paint splashes <b>c)</b> Washing floors, cleaning glass, joineries, electrical fittings etc and leaving the premise clean and tidy.	Sqft	100.00		
51	<b>POP Punning :</b> Providing and applying POP Punning on walls and columns (average 12mm thk). The rate shall include scrapping, levelling and preparing the surface. The rate shall be inclusive of all types of grooves above the skirting, around the window and door frames. <b>Note:</b> Rate quoted is deemed to include for <b>a)</b> Providing and removal of scaffolding wherever necessary <b>b)</b> Covering doors, windows, floors, fittings etc to protect from paint splashes <b>c)</b> Washing floors, cleaning glass, joineries, electrical fittings etc and leaving the premise clean and tidy. <b>d)</b> If the average thickness is found to 8mm~6mm or less, then POP will be considered as pulti finish - at the rate of - 50% the quoted rate	Sqft	150.00		

52	<p>Preparing the surface of wall/ceiling and applying two coat of <b>premium plastic emulsion paint</b> of first quality, approved brand and colour, manufactured by Asian paints/Berger, confirming to relevant IS over a coat of primer etc., complete all as specified &amp; directed by Officer-in-charge. Note : rate quoted is deemed to include for a) Providing and removal of scaffolding wherever necessary b) Covering doors, windows, floors, fittings etc to protect from paint splashes c) Washing floors, cleaning glass, joineries, electrical fittings etc and leaving the premises clean and tidy premise clean and tidy.</p>	Sqft	400.00		
53	<p>Preparing the surfaces of walls/ceiling and applying two coats of plastic emulsion paint of <b>M/s. Asian Royale Emulsion/Berger Luxol Silk</b> of approved colour, conforming to relevant IS over a coat of primer after successively drying each coat and finishing with sponge roller(matt finish) etc., complete all as specified and directed by Officer in charge. <b>Note:</b> The rate quoted is deemed to include for providing and removal of scaffolding wherever necessary. The rate is also inclusive of <b>a)</b> covering doors windows, floors, fittings etc., to protect from splashes. <b>b)</b> Washing floors, cleaning glass, joinery, electric fittings etc., and leaving the premise clean and tidy.</p>	Sqft	320.00		
54	<p>Providing and applying painting two or more coats of acrylic light textured emulsion paint over a coat of primer of first quality, approved brand and colour, Confirming to relevant IS, manufactured by M/s Asian paints/Berger, etc, complete all as specified and directed by Officer in charge.</p>	Sqft	140.00		
55	<b>PEBBLE DASH PLASTER</b>				



	Pebble dash plaster upto 10 m height above ground level with a mixture of washed pebble or crushed stone 6 mm to 12.5 mm nominal size, dashed over and including fresh plaster in two layers under layer 12 mm cement plaster 1:4 (1 cement : 4 coarse sand) and top layer 10 mm cement plaster with cement mortar 1:3 (1 cement : 3 fine sand) mixed with 10% finely grounded hydrated lime by volume of cement	Sqft	50.00		
	<b>Total (Rs.)</b>				

<b>B) SCHEDULE - 'B' (ELECTRICAL WORK)</b>					
<b>SL No</b>	<b>PARTICULARS</b>	<b>UNIT</b>	<b>QTY</b>	<b>RATE</b>	<b>AMT</b>
<b>1</b>	<b>ELECTRICAL WIRING &amp; EARTHING</b>				
1.1	Supply,laying,connection & testing of light,fan point, wiring by 2x1.5mmsq(2x3/.029) +1x1mmsq PVC insulated, multistrand single core copper conductor FRLS wire maintaining the colour code as per direction in PVC conduit of 20mm with ISI mark 1.5mm thickness to conceal in wall partition mending good the damage, complete with PVC circular box, bend to be done as per drawing including 3 point ceiling rows wherever required GI saddle to be used for fixing, metal flexiable/PVC flexible pipe may use if required in partition wall. All PVC pipes should be with ISI mark. No joints will be allowed inside pipe,light, fan & plug point complete with modular type switch plate & MS box . rate Including the main circuit line 2x2.5mmsq+1x1.5mmsq earth PVC insulated Cu. Wire from DB to switch board, maintaining the colour code. Circuit line for lighting switch board & 6Amps plug board are to be drawn from lighting DB to Lighting board & plug point board (independent), 6/16 Amps plug point line are to be draw from power DB.as per DB schedule /SLD				
a)	1 light by 1 switch	Nos.	17		
b)	2 light by 1 switch	Nos.	12		
c)	Same as above, but for exhaust fan excluding regulator.	No	1.00		
d)	Same as above 5A Point in the switchboard itself.	No	4.00		
e)	Wiring (2x2.5mmsq+1x1.5mmsq from power DBs) for independent 6A multi pin socket at walls along with 6A modular type switches board housed in painted MS box (upto 3 independent plug points can be taken in one circuit). For wall Fan	No	4.00		
1.2	<b>ACs electrification :-</b>				
a)	Supply and fixing 25 Amps 3-pin modular socket with 25 Amp one way switch with indicator (near AC indoor unit) housed in manufacturers MS powder coated box to be concealed in wall including Wiring using 2R4.0 sqmm & single run of 2.5 sqmm PVC insulated multi stranded single core copper conductor FRLS wire in 25mm PVC conduit to be laid in floor, partitions, etc complete with all accessories. (for split AC units) -(from Stabilizer to IDU)Supply. (2 Nos for ATM), Stabilizer to be installed in the panel room.	Nos	3.00		
<b>2</b>	<b>LAYING OF CABLE :</b>				





NABARD

2.1	- Do - 3.5 x 25 sqmmth with 02 nos 8 SWG bear GI.wire as running earth. for POWER & A.C D.B , UPS & ATM	Mts	25		
2.2	- Do - termination of 25 & 16 Sqmm 3.5 Core	Nos	8		
2.3	<b>LIGHTING DB Make standard/Legrand/ABB</b>				
	<b>6 way TPN MCB DB with TP MCB as incoming</b>				
	63A TP&N MCB as main				
	32 AMPS DB MCB 1No: For Strong room )				
	16 Amps SP MCB - 03 Nos.+ (BM +Toilet) each 1No + 1No spare				
	12 Amps SP MCB - 12 Nos. (Hall - 4Nos + Store room 1 No +External Lighting 1No.:+ Ups 1No + wall Fan 3 Nos.2 No spare)				
	Including Neutral Bar. 01 Set	Set	1		
	<b>Sub total I</b>	-		-	-
<b>3</b>	<b>ELECTRICAL FITTINGS (S/I/T/C)</b>				
3.1	Supply and Installation Recess mounted 2'-0"X2'-0" watt ,38 W LED FULL GLOW Philips MAKE . Light should be fixed through SS threaded bolt tightened the upper end on ceiling using anchor bolt and lower end on Light fitting with nut and bolt (RC380B G2 LED35S-6500/4000 PSU OD WH) <b>PHILIPS/WIPRO MAKE</b>	Nos.	15		
3.2	Supply, Installation, testing and commissioning of single coloured , 8 meter LED light strip of 5W per meter complete with necessary drivers, all accessories and etc for cove lighting in column panelling (Bajaj BCFL 300 25W/ Wipro LS 06 005 120/ Philips/Crompton) including connection & mounting arrangement as required w.r.t site conditions.(Fitting and drivers shall be of IP20 protection class)	Nos.	2		
3.3	Round SHAPE DOWNLIGHTER - INTEGRA 15W, 3000K, LHEBGTP5Z1W015, <b>PHILIPS Razor/WIPRO MAKE</b>	Nos.	24		
3.4	TUBELIGHT - TITANIA SLEEK NEW T5 LED TUBELIGHT 18W, LHLDCNVENL8Z018, <b>PHILIPS/WIPRO MAKE.</b>	Nos	1		
3.4	Wall mounting fan 400 mm dia 230 volt A.C.	Nos.	5		
<b>4</b>	<b>MUSIC - CUM - PA - SYSTEM</b>				
a)	S & I of point wiring for music - cum PA system comprising of 2x 1.0 sqmm stranded, copper conductor , flexible PVC insulated and PVC Sheathed wire pulled through 20 mm dia .PVC heavy gauge conduits and looped from one speaker to other and to the volume control and control switch wherever applicable and finally terminated at Tag Block.	pts	6		
b)	S & I of Philips / Bosch/Ahuja make music speaker flush mounted on the false ceiling with proper clamping arrangement	Nos.	6		
	<b>SUB TOTAL</b>				



	<b>TOTAL FOR ELECTRICAL WORK (B)</b>				
	<b>* GST EXTRA AS APPLICABLE</b>				

**Note:**

1. Indicative make of the Product is indicated above: Warranty Certificate of the electrical and electronic items shall also be submitted.
2. The Quoted rate shall be workable and inclusive of all material and labour cost as well as contractor profit, overheads/Income Tax as applicable.
3. The contractor should have valid GST registration. While raising final bill, the contractor should write their GSTIN number in the Tax Invoice and should clearly indicate applicable SGST/ CGST amounts payable.
4. The contractors should visit site and assess site conditions and scope of work before quoting the rates.
5. The contractor should clean the work area on daily basis and remove all the debris of work as and when instructed by NABARD.
6. Items 2, 3, 4, 5 & 7 are indicative quantities based on estimates. However, the quantity for payment shall be made as per actual quantity executed.
7. The work shall be awarded to the vendor quoting the lowest price (L-1) for the work and meeting the specifications and terms and conditions as specified in the document inviting quotations.
8. The contractor has to quote for all the items in the price bid/quotation. Incomplete price bids shall be rejected.

**Accepted all terms & conditions.**

Place:

Date:

**(Name, Address and Seal of the contractor)**



**Pro-forma of Payment details (Annexure-I)**  
**Notice Inviting Tender for Renovation of Gymnasium at NBSC & BIRD Campus**  
**– Civil and Electrical Works**

Name of the Agency		
Contact Details	Name	
	Email	
	Phone No	
PAN details (enclose copy of PAN)		
GST Number (enclose copy of GST registration)		
Address of principle place of business in the state as per GST registration certificate	Address	
	City	
	PIN	
	State	
Bank account number		
Account Name		
Type of the account		
Name & Address of Bank		
IFSC Code ( <b>enclose copy of cancelled cheque</b> )		

Name of the Agency:

Date:

Place:

Signature with seal:



## Annexure - II

### VIRTUAL COMPLETION CERTIFICATE

Having executed the work in terms of the contract, we hereby certify and affirm that we have virtually completed the contracted works on \_\_\_\_\_.

We hereby certify that the work has been executed wholly to our satisfaction and with materials and workmanship in accordance with the contract.

We do certify further that we have executed the work in accordance with the applicable laws and without any transgression of such laws.

Signature of the Contractor:

Signature of the NABARD :

Place :

Place :

Date :

Date :

Name :

Name :

Address :

Address :

Seal :

Seal :

**Annexure - I**

<b>S.No</b>	<b>Name of Empanelled Contractors</b>	<b>Address</b>
1	M/s Speed Vision Engineering & Construction Works	551JA/89, D-Cruse Compound, Ram Prasad Khera, Lucknow
2	M/s Sri Krishan	H. No. 35, Rasoolpur, Kayasth, Madiyaon, Lucknow
3	M/s Siddhartha Constructions	108/157, New Model House, Lucknow
4	M/s Megatech Engineering & Construction	551JA/89, D-Cruse Compound, Ram Prasad Khera, Lucknow
5	M/s Shailendra Construction	B. O. 15, Saidpur Jageer, Jankipuram, Lucknow
6	M/s Kamna Engineers	UGF.27, Viraj Khand, Gomti Nagar, Lucknow
7	M/s Devam Enterprises	B. O. 15, Saidpur Jageer, Jankipuram, Lucknow
8	M/s Suresh Prasad Tiwari	Tanda, Barahalganj, Gorakhpur
9	M/s R S Enterprises	B-39, Sarvodaya Nagar, Lucknow
10	M/s Anirudh Electrical	Dichoan Enclave, Gali No. 4, Najafgarh, New Delhi
11	M/s Infra Solution	H No. 195, Gupta Enclave, Uttam Nagar, New Delhi
12	M/s Raghava Constructions	569, Shakti Khand 3, Indirapuram, Ghaziabad
13	M/s Johar Infrastructures	206, Gulmarg Apartment, Moti Nagar, Lucknow
14	M/s Chitrakoot Constructions	Sec-16A, 133, Vrindavan Yojna, Lucknow

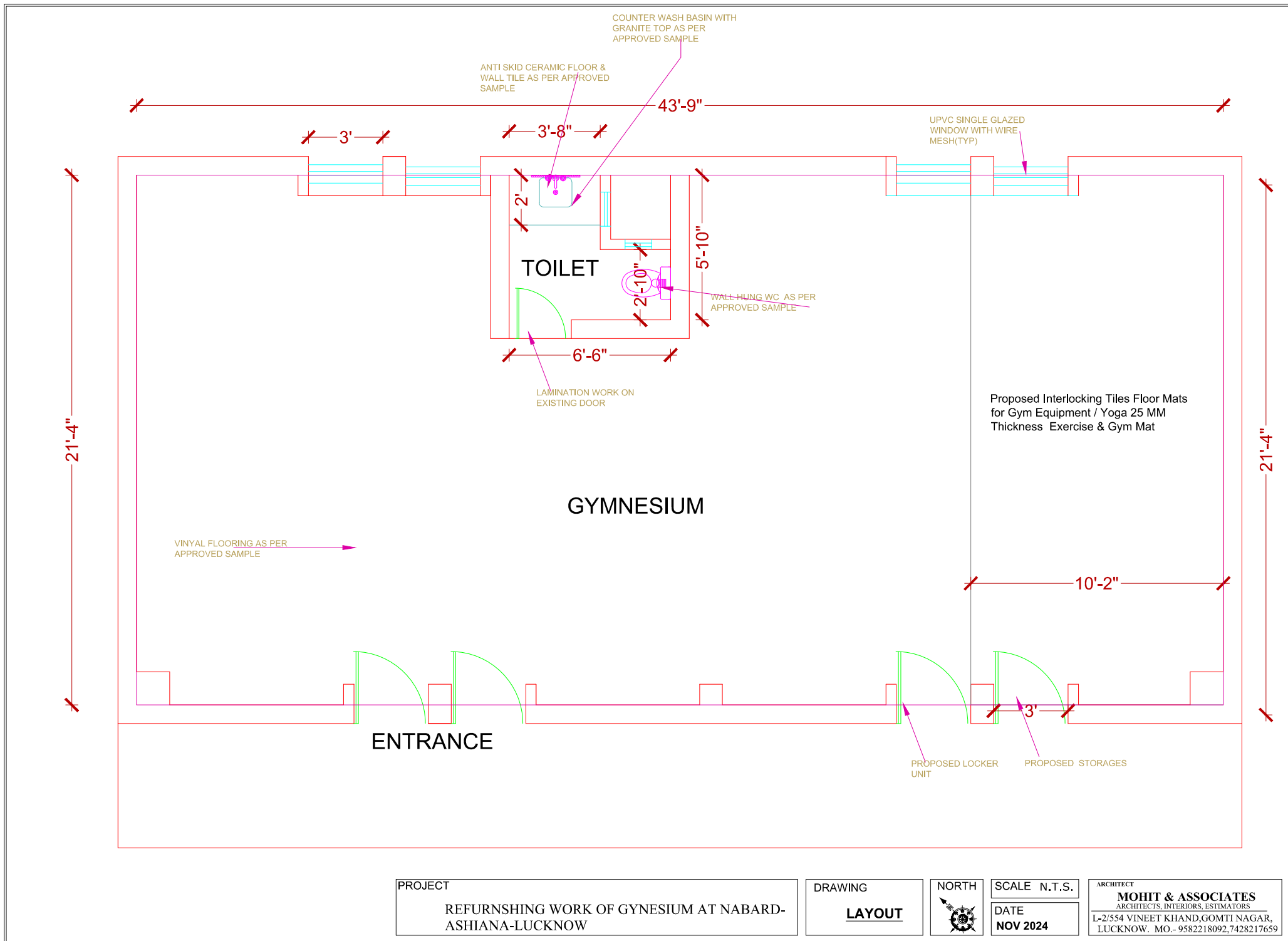

PROJECT  
 REFURNISHING WORK OF GYNESIUM AT NABARD-ASHIANA-LUCKNOW

DRAWING  
**LAYOUT**



SCALE N.T.S.  
 DATE  
**NOV 2024**

ARCHITECT  
**MOHIT & ASSOCIATES**  
 ARCHITECTS, INTERIORS, ESTIMATORS  
 L-2/554 VINEET KHAND,GOMTI NAGAR,  
 LUCKNOW. MO.- 9582218092,7428217659